

|       |           |          |
|-------|-----------|----------|
| TWR   | 118.2(E)  | 118.8(W) |
| GND   | 121.75(E) | 121.7(W) |
| APRON | 121.65    | 122.175  |
|       | 121.8     | 123.325  |

ELEVATIONS AND DIMENSION IN METERS  
BEARINGS ARE MAGNETIC



ANNUAL RATE OF CHANGE  
6' W

| LEGEND |   |
|--------|---|
|        | VOR CHECK-POINT AND FREQUENCY           |
|        | Stop-bar light                          |
|        | Holding position                        |
|        | Taxi lane                               |
|        | Gate                                    |
|        | Remote stand                            |
|        | Taxi routes                             |
|        | De-icing pad taxi routes                |
|        | Powered taxi-start point                |
|        | Transfer of control point(TCP)          |
|        | Open Channel                            |
|        | Hot Spot                                |
|        | ATC service boundary (Maneuvering Area) |
|        | RPBB (Remote Passenger Boarding Bridge) |

Note  
All aeroplane will taxi at speeds of more than 10 kt on Taxiways A, B, C, D, M, N or P to ensure smooth traffic flow unless there is exceptional direction concerning safety factors by ATC. And if it is impracticable, pilots shall notify to ATC.

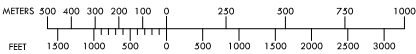

|                |   |
|----------------|---|
| HS 1           | AIRCRAFT TAXIING ON TAXIWAY J FROM RUNWAY 15L AFTER LANDING USE CAUTION WHEN ATC UTILIZES RUNWAY 15R FOR TAKEOFFS. DO NOT CROSS THE HOLDING MARKING FOR RUNWAY 15R WITHOUT ATC AUTHORIZATION. |
| HS 2           | AIRCRAFT TAXIING ON TAXIWAY K FROM RUNWAY 33R AFTER LANDING USE CAUTION WHEN ATC UTILIZES RUNWAY 33L FOR TAKEOFFS. DO NOT CROSS THE HOLDING MARKING FOR RUNWAY 33L WITHOUT ATC AUTHORIZATION. |
| HS 21 ~ 24, 29 | USE CAUTION OF CONFUSION ON TAXIWAYS. DO NOT PROCEED TAXIING BEYOND TRANSFER OF CONTROL POINTS WITHOUT CLEARANCE FROM INCHEON APRON OR GROUND(TOWER).   |
| HS 25 ~ 28     | USE CAUTION OF CONFUSION ON TAXIWAYS.   |

Note 1  
When non-standard taxi routes are applicable, Incheon APRON will issue transition taxi instructions one to another taxiway in APRON 2, APRON 3, APRON 4 and Cargo APRONS.

Note 2  
Aircraft shall not taxi into maneuvering area without clearance from Incheon Tower or Ground.

|       |  | SURFACE  | WIDTH   | STRENGTH       |
|-------|--|----------|---|----------------|
| APRON | Apron 1, 2<br>Cargo Apron 1<br>Maintenance Apron | Concrete | -   | PCN 86/R/B/X/T |
|       | Apron 3, 4<br>Cargo Apron 2                      |          |   | PCN 85/R/B/X/T |
|       | TWY A, D   | Concrete | 30 m<br>Shoulder : 15 m<br>- Paved : 12 m<br>- Turfed : 3 m | PCN 86/R/B/X/T |
|       | TWY B, C   | Asphalt  |   | PCN 88/F/B/X/T |
|       | TWY M  | Concrete | 30 m<br>Shoulder : 15 m<br>- Paved : 15 m                   | PCN 85/R/B/X/T |
|       | TWY N  | Asphalt  |   | PCN 75/F/B/X/T |
|       | TWY P  | Asphalt  |   | PCN 75/F/B/X/T |

Taxiway edge lights on all taxiways curve area  
Taxiway center line lights on all taxiways  
PAX Terminal and Concourse A VDGS equipped



AERODROME GROUND  
MOVEMENT CHART - ICAO

APRON ELEV 6 m

|       |           |          |
|-------|-----------|----------|
| TWR   | 118.2(E)  | 118.8(W) |
| GND   | 121.75(E) | 121.7(W) |
| APRON | 121.65    | 122.175  |
|       | 123.675   | 123.325  |

SEOUL / Incheon Intl  
RWY 15L/R, 33L/R ARRIVAL

RKSI AD CHART 2 - 7  
25 AUG 2022

ELEVATIONS AND DIMENSION IN METERS  
BEARINGS ARE MAGNETIC



ANNUAL RATE OF CHANGE  
6' W

| LEGEND |   |
|--------|---|
|        | VOR CHECK-POINT AND FREQUENCY           |
|        | Stop-bar light                          |
|        | Holding position                        |
|        | Taxi lane                               |
|        | Gate                                    |
|        | Remote stand                            |
|        | Taxi routes                             |
|        | Alternate Taxi routes                   |
|        | Transfer of control point(TCP)          |
|        | Open Channel                            |
|        | Hot Spot                                |
|        | ATC service boundary (Maneuvering Area) |
|        | RPBB (Remote Passenger Boarding Bridge) |

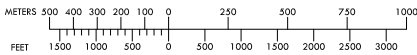

|              |   |
|--------------|---|
| HS 1         | AIRCRAFT TAXIING ON TAXIWAY J FROM RUNWAY 15L AFTER LANDING USE CAUTION WHEN ATC UTILIZES RUNWAY 15R FOR TAKEOFFS. DO NOT CROSS THE HOLDING MARKING FOR RUNWAY 15R WITHOUT ATC AUTHORIZATION. |
| HS 2         | AIRCRAFT TAXIING ON TAXIWAY K FROM RUNWAY 33R AFTER LANDING USE CAUTION WHEN ATC UTILIZES RUNWAY 33L FOR TAKEOFFS. DO NOT CROSS THE HOLDING MARKING FOR RUNWAY 33L WITHOUT ATC AUTHORIZATION. |
| HS 21~24, 29 | USE CAUTION OF CONFUSION ON TAXIWAYS. DO NOT PROCEED TAXIING BEYOND TRANSFER OF CONTROL POINTS WITHOUT CLEARANCE FROM INCHEON APRON OR GROUND(TOWER).   |
| HS 25~28     | USE CAUTION OF CONFUSION ON TAXIWAYS.   |

Note 1  
All aeroplane will taxi at speeds of more than 10 kt on Taxiways A, B, C, D, M, N or P to ensure smooth traffic flow unless there is exceptional direction concerning safety factors by ATC. And if it is impracticable, pilots shall notify to ATC.

Note 2  
When non-standard taxi routes are applicable, Incheon APRON will issue transition taxi instructions one to another taxilane in APRON 2, APRON 3, APRON 4 and Cargo APRONS.

CAUTION  
For Gate 11 and 42, pilots needs to pay extra caution to follow the lead lines, which may require more than two turns.

|          |  | SURFACE  | WIDTH   | STRENGTH       |
|----------|--|----------|---|----------------|
| APRON    | Apron 1, 2<br>Cargo Apron 1<br>Maintenance Apron | Concrete | -   | PCN 86/R/B/X/T |
|          | Apron 3, 4<br>Cargo Apron 2                      |          |   | PCN 85/R/B/X/T |
| TWY A, D |  | Concrete | 30 m<br>Shoulder : 1.5 m<br>- Paved : 1.2 m<br>- Turfed : 3 m | PCN 86/R/B/X/T |
| TWY B, C |  | Asphalt  |   | PCN 88/F/B/X/T |
| TWY M    |  | Concrete |   | PCN 85/R/B/X/T |
| TWY N    |  | Asphalt  | 30 m<br>Shoulder : 1.5 m<br>- Paved : 1.5 m                   | PCN 75/F/B/X/T |
| TWY P    |  | Asphalt  |   | PCN 75/F/B/X/T |

Taxiway edge lights on all taxiways curve area  
Taxiway center line lights on all taxiways  
PAX Terminal and Concourse A VDGS equipped

Change : Information of aerodrome ground movement chart for RWY 15L/R, 33L/R arrival.



AERODROME GROUND  
MOVEMENT CHART - ICAO

APRON ELEV 6 m

|       |           |          |
|-------|-----------|----------|
| TWR   | 118.2(E)  | 118.8(W) |
| GND   | 121.75(E) | 121.7(W) |
| APRON | 121.65    | 122.175  |
|       | 121.8     | 123.325  |

SEOUL / Incheon Intl  
RWY 16L/R, 34L/R DEPARTURE

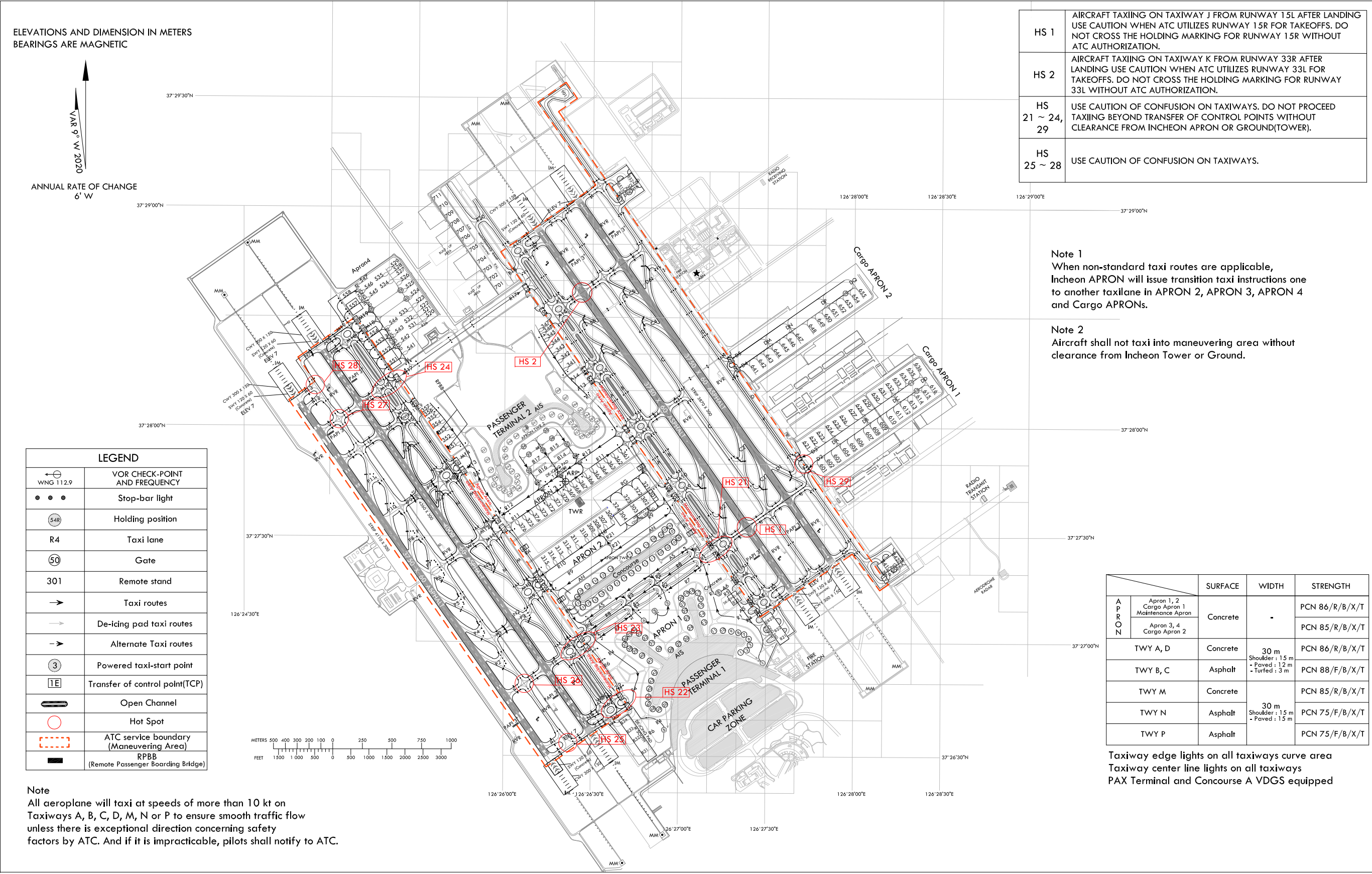

|                |   |
|----------------|---|
| HS 1           | AIRCRAFT TAXIING ON TAXIWAY J FROM RUNWAY 15L AFTER LANDING USE CAUTION WHEN ATC UTILIZES RUNWAY 15R FOR TAKEOFFS. DO NOT CROSS THE HOLDING MARKING FOR RUNWAY 15R WITHOUT ATC AUTHORIZATION. |
| HS 2           | AIRCRAFT TAXIING ON TAXIWAY K FROM RUNWAY 33R AFTER LANDING USE CAUTION WHEN ATC UTILIZES RUNWAY 33L FOR TAKEOFFS. DO NOT CROSS THE HOLDING MARKING FOR RUNWAY 33L WITHOUT ATC AUTHORIZATION. |
| HS 21 ~ 24, 29 | USE CAUTION OF CONFUSION ON TAXIWAYS. DO NOT PROCEED TAXIING BEYOND TRANSFER OF CONTROL POINTS WITHOUT CLEARANCE FROM INCHEON APRON OR GROUND(TOWER).   |
| HS 25 ~ 28     | USE CAUTION OF CONFUSION ON TAXIWAYS.   |

Note 1  
When non-standard taxi routes are applicable, Incheon APRON will issue transition taxi instructions one to another taxilane in APRON 2, APRON 3, APRON 4 and Cargo APRONS.

Note 2  
Aircraft shall not taxi into maneuvering area without clearance from Incheon Tower or Ground.

|          | SURFACE  | WIDTH   | STRENGTH       |
|----------|--|---|----------------|
| APRON    | Apron 1, 2<br>Cargo Apron 1<br>Maintenance Apron | Concrete  | PCN 86/R/B/X/T |
|          | Apron 3, 4<br>Cargo Apron 2                      | Concrete  | PCN 85/R/B/X/T |
| TWY A, D | Concrete   | 30 m<br>Shoulder : 15 m<br>- Paved : 12 m<br>- Turfed : 3 m | PCN 86/R/B/X/T |
| TWY B, C | Asphalt  |   | PCN 88/F/B/X/T |
| TWY M    | Concrete   |   | PCN 85/R/B/X/T |
| TWY N    | Asphalt  | 30 m<br>Shoulder : 15 m<br>- Paved : 15 m                   | PCN 75/F/B/X/T |
| TWY P    | Asphalt  |   | PCN 75/F/B/X/T |

Taxiway edge lights on all taxiways curve area  
Taxiway center line lights on all taxiways  
PAX Terminal and Concourse A VDGS equipped

Change : Information of aerodrome ground movement chart for RWY 16L/R, 34L/R departure.



AERODROME GROUND  
MOVEMENT CHART - ICAO

APRON ELEV 6 m

TWR 118.2(E) 118.8(W)  
GND 121.75(E) 121.7(W)  
APRON 121.65 122.175 123.675  
121.8 123.325

RKSI AD CHART 2 - 9  
25 AUG 2022  
SEOUL / Incheon Intl  
RWY 16L/R, 34L/R ARRIVAL

